

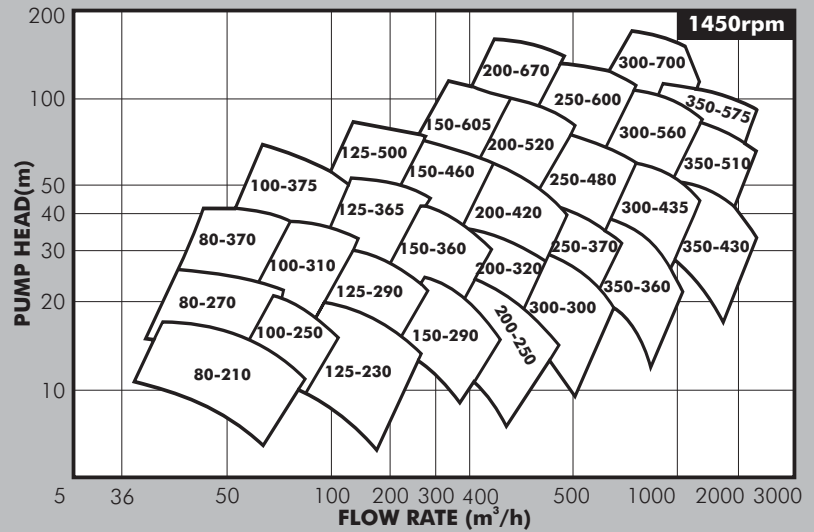

DSC

**Split Casing
Pumps**

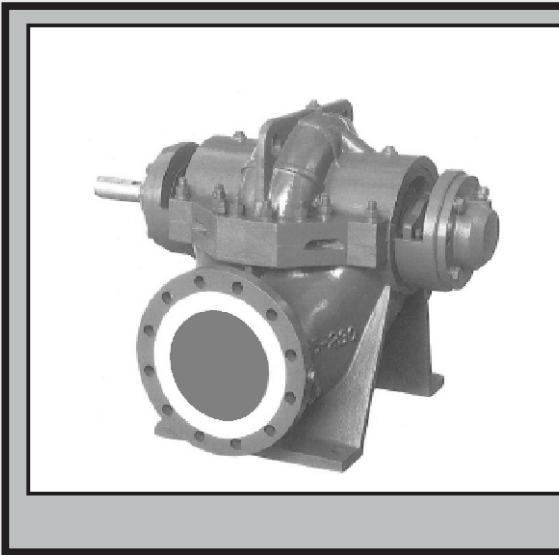

PUMP

DAYLIFF DSC split casing pumps are for high flow applications in municipal water supply, irrigation, industry and air conditioning. Features include a double suction arrangement, stiffened pump casing, compact shaft for extended service life and internal cooling to the inner seal housing, the option of gland packing or mechanical seal being available. Materials of construction are cast iron pump body and bronze impeller, other materials of construction being available as may be required for special applications. Pumps are available to special order only and the standard impeller can be trimmed to provide the exact duty required. Details of individual pump performance is available on provision of the duty requirements.

OPERATING PARAMETERS

- Pumped Liquid:** Thin, clean, chemically non aggressive liquids without solids or fibres
- Max Operation Pressure:** 16 bar
- Max Temperature:** 105°C

PUMP DATA

Model	Max HP	Flange (mm)		Dimensions (mm)						Weight (kg)
		DN1	DN2	a	h	h1	m	n	l	
DSC 80-270	30	125	80	660	540	315	320	410	685	209
DSC 100-375	55	150	100	740	640	355	320	470	685	245
DSC 125-500	110	200	125	900	715	400	390	640	850	414
DSC 150-605	250	200	150	1100	885	500	480	780	920	755
DSC 200-670	500	250	200	1200	920	600	500	800	1078	1218
DSC 250-600	630	300	250	1200	1050	630	600	800	1210	1116
DSC 300-700	1100	400	300	1400	1235	750	620	1060	1350	1640
DSC 350-660	1100	450	350	1400	1255	780	620	1060	1350	1900

Pump details are given for maximum impeller diameter

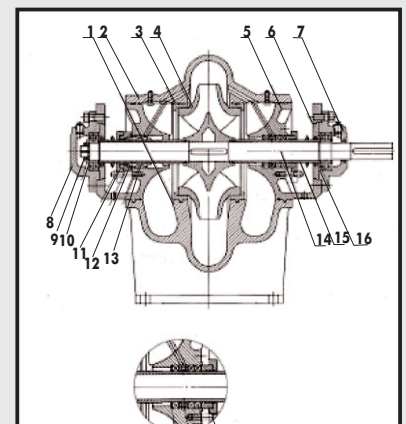
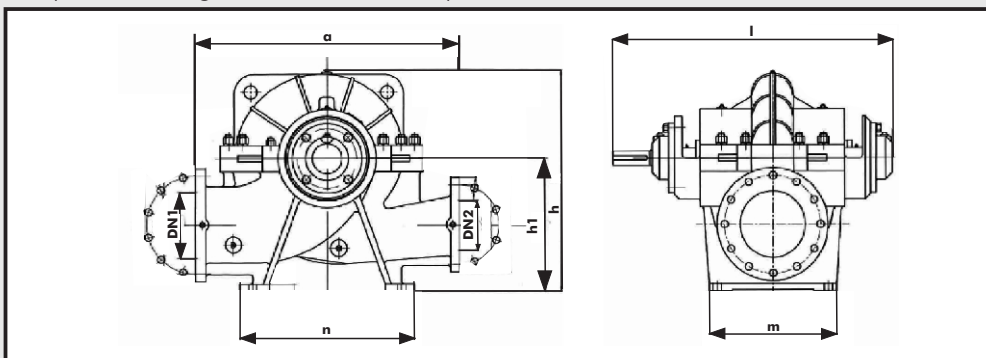

- 1. Casing
- 2. Casing Cover
- 3. Wear Ring
- 4. Impeller
- 5. Seal Housing
- 6. Bearing Cover
- 7. Drive End Bearing Housing
- 8. Non-drive End Bearing Housing
- 9. Lock Nut
- 10. Bearing Baffle
- 11. Seal Plate
- 12. Seal Cover
- 13. Mechanical Seal
- 14. Shaft
- 15. Shaft Sleeve
- 16. Bearing Pressing Ring
- 17. Packing Pressing Ring
- 18. Seal Cage
- 19. Gland Packing
- 20. Gland Cover