

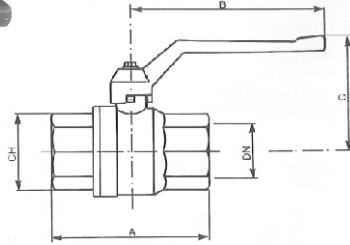

Brass Ball Valves & Cocks

Ball Valves

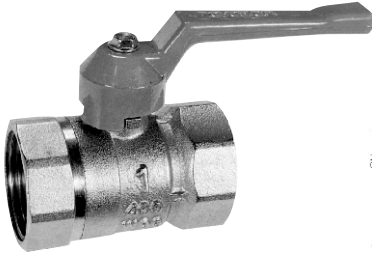

- Full Port ball
- Aluminum Lever Handle
- FxF BSP Thread
- Maximum 45 Bar Working

Size	1/2"	3/4"	1"	1 1/4"	1 1/2"	2"	2 1/2"	3"	4"
DN	15	20	25	32	40	50	62	75	100
CH	25	31	38	48	54	67	81	95	122
C	47	51	63	68.5	84	92	126	154	173
B	75	75	110	110	140	140	175	250	250
A	46	56.5	65.5	77	88.5	101.5	129.5	146	181

Ball Hose Cocks

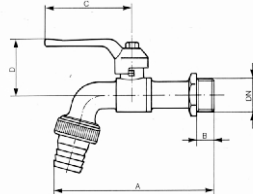

- Aluminium Lever Handle
- Hose End Included
- Male BSP Connection

Size	1/2"	3/4"
DN	10	12
A	105	120
B	11	14
C	75	75
D	45	45

Mini Ball Cocks

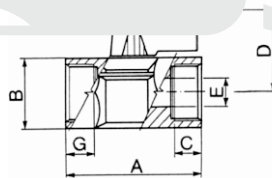
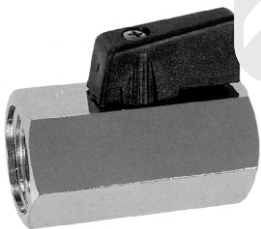

- Reduced Port
- FxF BSP Thread
- Maximum Working Pressure 10 Bar

Size	3/8"	1/2"
A	42	47
B	21	25
C	9	10,5
D	27	29
E	8	10
F	22	22

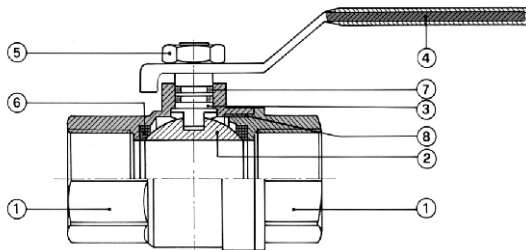

MATERIAL

1. **Forged body and connector:** Brass OT 58 CuPb2ZnSn
2. **Ball:** Brass, solid OT 58 CuPb2ZnSn
3. **Stem:** Brass OT 58 CuPb2ZnSn
4. **Lever handle:** Steel or Aluminum
5. **Screw for lever:** Brass
6. **Ball Seat:** PTFE pure
7. **Steam Seal:** O-ring in VITON/NBR
8. **Thread Seal:** Loctite 2701 (DIN 30661)

NB: All valves with bottom entry blow-out proof stem.